

## Junction boxes

### Assembled round Ø73

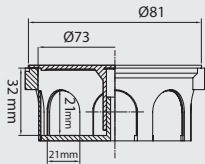

RAL 1023





**Application Standards**  
EN 60670-22, EN 60754-2



#### Properties

Box raw material	Heavy metals free (RoHS), specially stabilized thermoplastic HIPS (base) and PO blend (cover plate)
Temperature range	-15°C µε +60°C
Electrical characteristics	With electrical insulated characteristics
Resistance to flame propagating	Non flame propagating
Resistance to heat	650°C
Conduit entries	8 up to Ø21
Ingress protection	IP2X

Ideal for flush mounting and cavity wall installations. Junction boxes can be assembled lengthwise.

Type	Part number		
Junction box	3010103	100	-
Cover plate	3211003	100	-



Packaging do not contain cover plates.